



Micromilk pumps

Type range: LH90 5M, LH90 6M

Rudolf Koller GmbH
Rudolf-Koller-Straße 1
A-3902 Vitis
Tel. +43/2841/8207
Fax. +43/2841/8221
E-Mail: office.vitis.at@rkoller.com

1946 Rev.1
Ing. Aigner A.

We reserve the right to make technical modifications and printing errors.

Pump Micromilk SR-PML-1350, SR-PML-1650

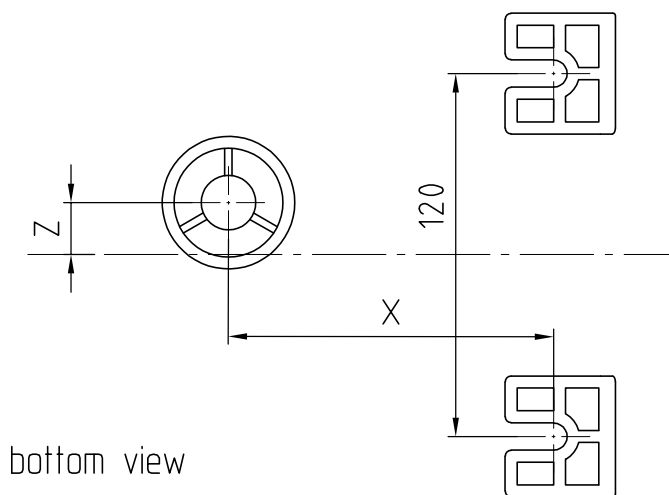
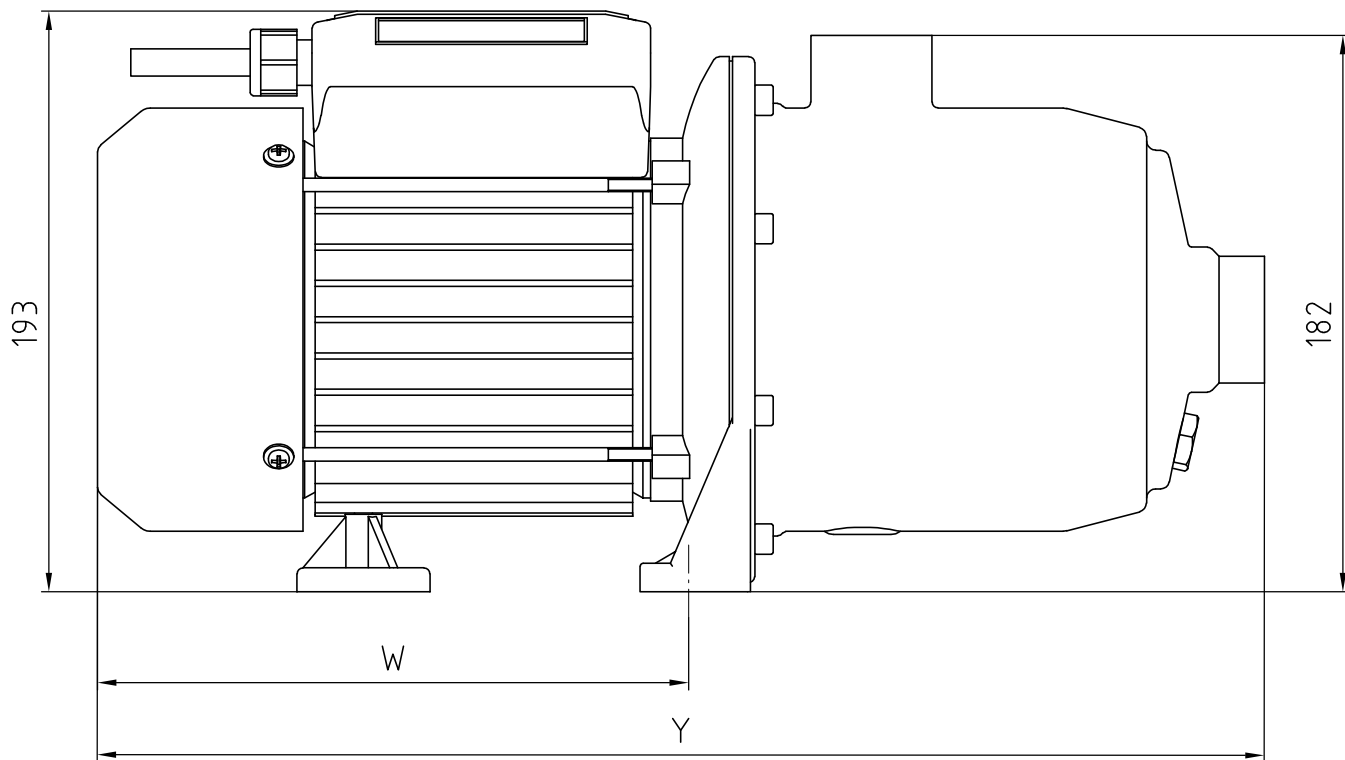

Type	LH90 5M	LH90 6M
Order No.	SR-PML-1350	SR-PML-1650
W	192	214
X	96	118
Y	386	430
Z	11±3	13±5

Technical data

Nominal voltage:	220-240V; 50Hz
Nominal power:	1350W, 1650W
max. operation pressure	5,2bar, 6,2bar
max. flow	90L/min, 90L/min
System of protection:	IP X5
Only suitable for inside use!	

1 Area of application and mode of operation

This pumps are part of the centrifugal pump family. This high pressure pumps have several pressure stages connected in series. They have been specially developed for the Micromilk production.

Do not operate the pump without water, because the pump shaft seal could be damaged.

In longer operation, the water heats up due to internal friction.

2 Versions available

2.1 Micromilk Pumps, 220-240V 50Hz

Type	Order number	Nominal power consumption P1 [W]	max. delivery height [m]	max. delivery volume [L/min]	Model	Emptying
LH90 5M	SR-PML-1350	1350	52,0	90,0	Standard	Cartridge
LH90 6M	SR-PML-1650	1650	62,0	90,0	Standard	Cartridge

nominal voltage: 220-240V 50Hz

system of protection: IPX5

insulation class: F

speed: 2800 1/min

3 Fitting the pump to the tub

Mount the pump so that residual water empties completely via the drain. Use connecting fittings from firm Koller (see main catalogue) to connect to the pipes. A vacuum fitting must be installed at the suction point of the bath. All cables that lead to the control mechanism shall be lengthened so that any electrical parts can be removed for repair without any problems.

4 Mounting the Koller Micromilk System

- 1) During assembly, decouple the pump acoustically via pump legs (rubber-metal buffer).
- 2) Position the suction fitting and inlet nozzles so that the pump fills with water.
- 3) The pump drainage must be connected to a drain and overflow with residual water drainage. Opening the drain also opens the residual water drain for the pump.
For SPA pools, a ball valve should be provided for the drainage of residual water.
- 4) The use of a Flatline suction fitting requires a safety suction (P-72033). It has to be installed behind the tub above the water level in the tub.
- 5) Install the air-suction-part (P-6926) behind the tub above the water level in the tub.
- 6) A 2 jet system (2 inlet nozzles) with the LH90 5M pump (SR-PML-1650) have only be installed on single person tubs (max. 400L) with a maximum water level height of 40 cm.
- 7) Systems with chrome-plated visible parts plastic chrome or brass chrome, have only be used for single person tubs without chemical additives (e.g. chlorine). The water must be drained after each use.
- 8) For SPA baths where the water is not drained and chlorinated water is used, only visible parts in plastic white, plastic gray or stainless steel V4A (ST4-xxxx) have to be used.
- 9) Layout sketches of Koller Micromilk systems see on page 5 to 8.

5 Hygiene notes

All pump parts will stand up to normal domestic cleaners.

CAUTION! Follow the cleaning instructions of the whirlpool manufacturer and the instructions for use of cleaning materials.

6 Safety instructions

Persons (including children), who due to their physical or mental abilities or their inexperience or unawareness are not able to use the equipment safe, should not use this equipment without supervision or instruction by a responsible person.

Children should be supervised, in order to guarantee that they do not play with the equipment.

Persons with long hair must wear a bathing cap to avoid hair being drawn into the suction line of the pump. Risk of drowning!

7 Electrical Installation

The electrical installation may only be done by an officially licensed electrical installation company. Furthermore, the installation regulations of the local utility company as well as the provisions of DIN 57100 or VDE 0100, Part 701, shall be strictly complied with.

The feed line [light plastic-sheathed cable H05VV-F3G1,5 (YMM-J 3x1.5 mm²) up to 2,700 W or H05VV-F3G2,5 (YMM-J 3x2,5 mm²) up to 3,500 W] has to be led over a residual current operated device (at least 25 A 230/400 V~ rated breaking current $I_{\Delta N}=0.03$ A) and secured with an overload release $I_N=16$ A or 25 A U-Type (in Austria: $I_N=13$ A or 16 A C type). It must be possible to switch off this circuit with an all-pole switch with at least 3 mm of contact gap width.

The potential equalisation line (at least 4 mm² of copper) must be connected at the place provided on the pump motor.

7.1 Connecting cable

Cable colour	function
brown	phase L
blue	neutral wire N
yellow/green	earth wire PE

The connecting cable must be replaced only by us or by an electrical firm authorized by us.

KOLLER MILK 2 JET P-X MIT RESTWASSERENTLEERUNG ANSCHLUSS WITH DRAINAGE OPTION

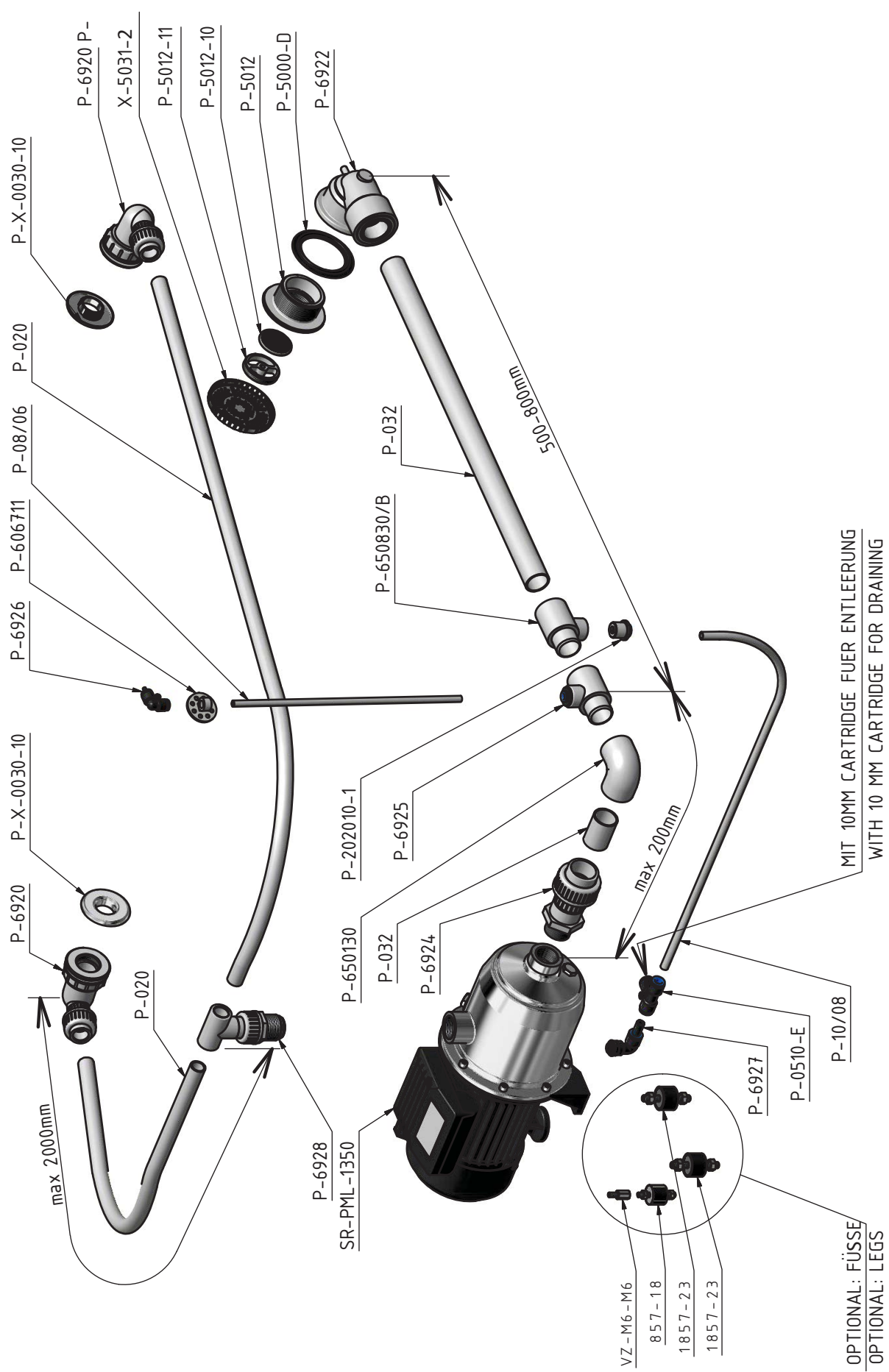

OPTIONAL: FÜSSE
OPTIONAL: LEGS

Systemaufbau : Max 400L

System construction : Max 400L

Füllhöhe : Max 40cm

Height of water level : Max 40cm

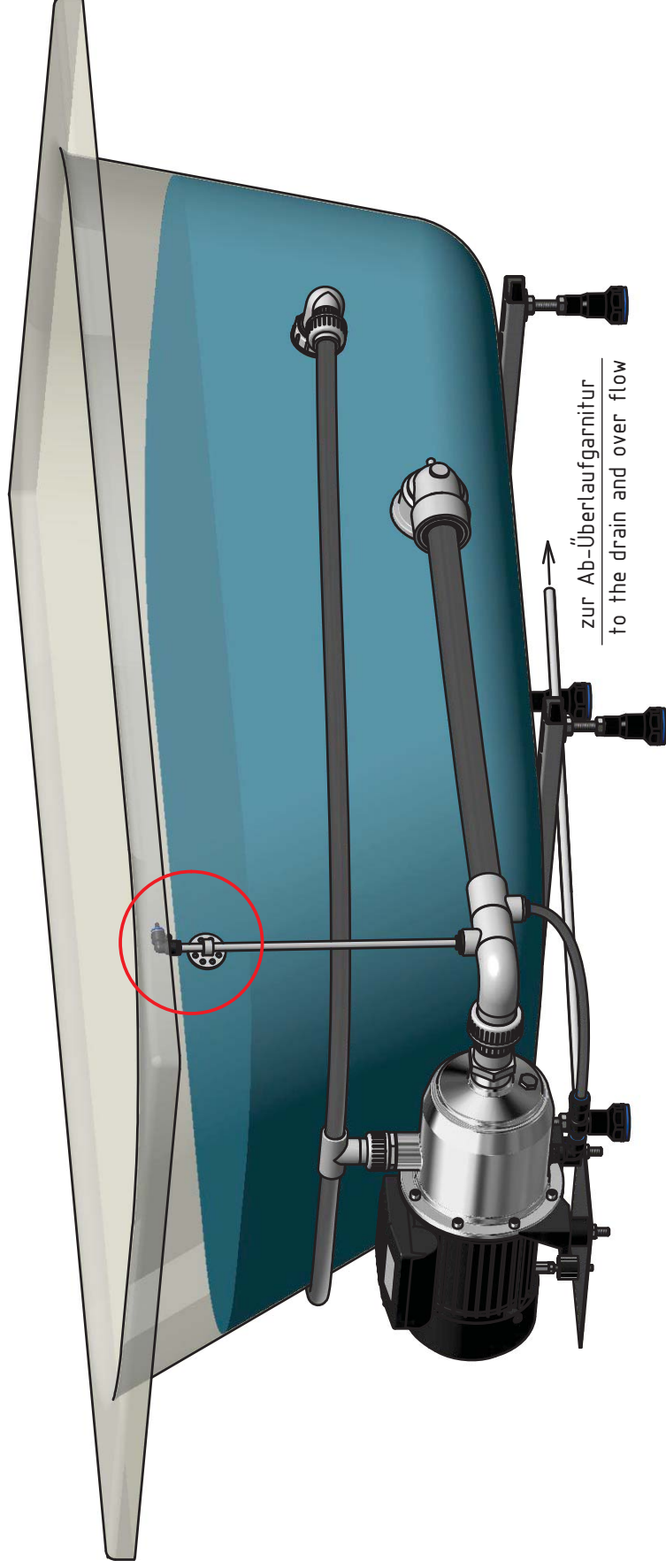

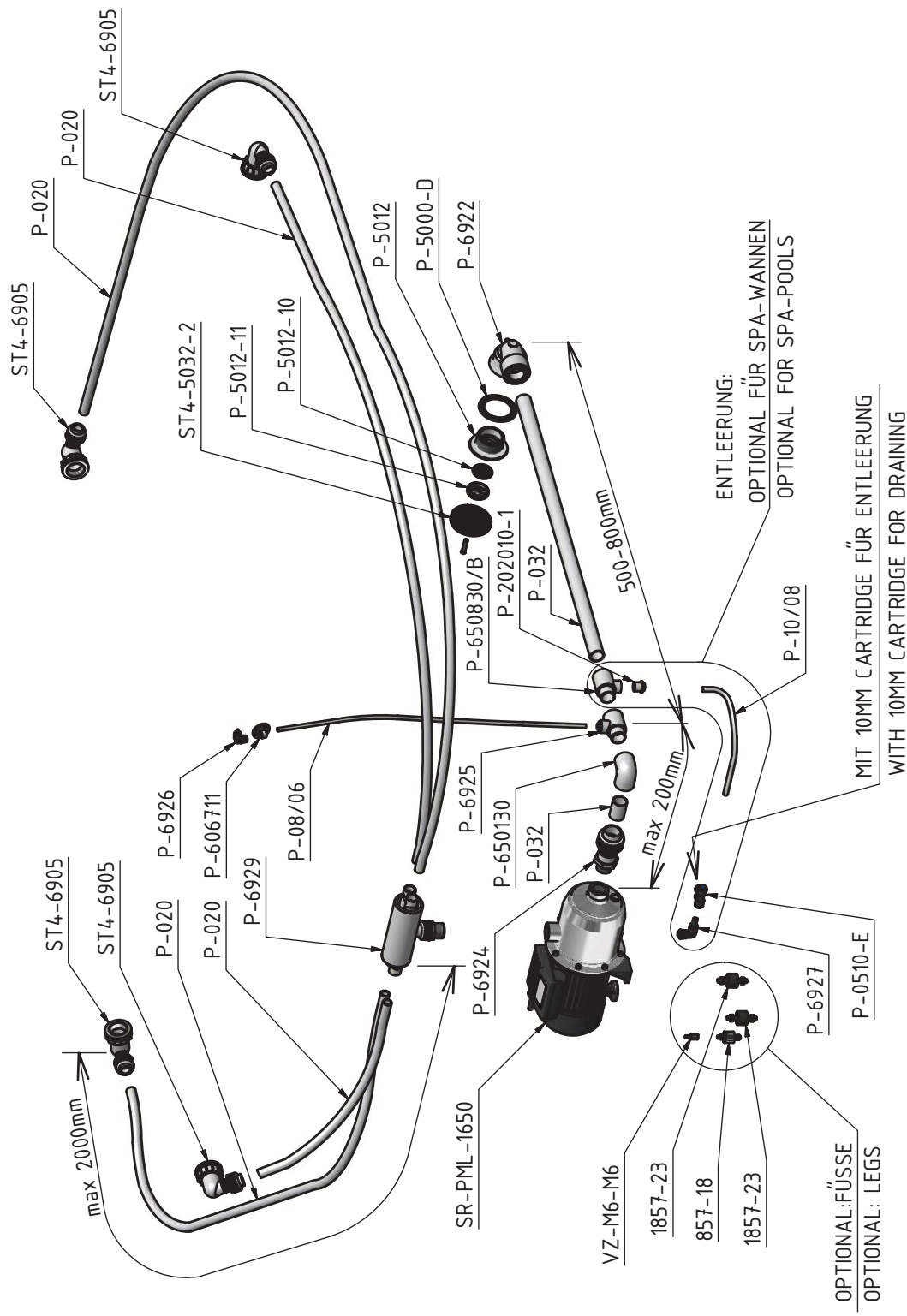

Systemaufbau: Max 800L

System construction: Max 800L

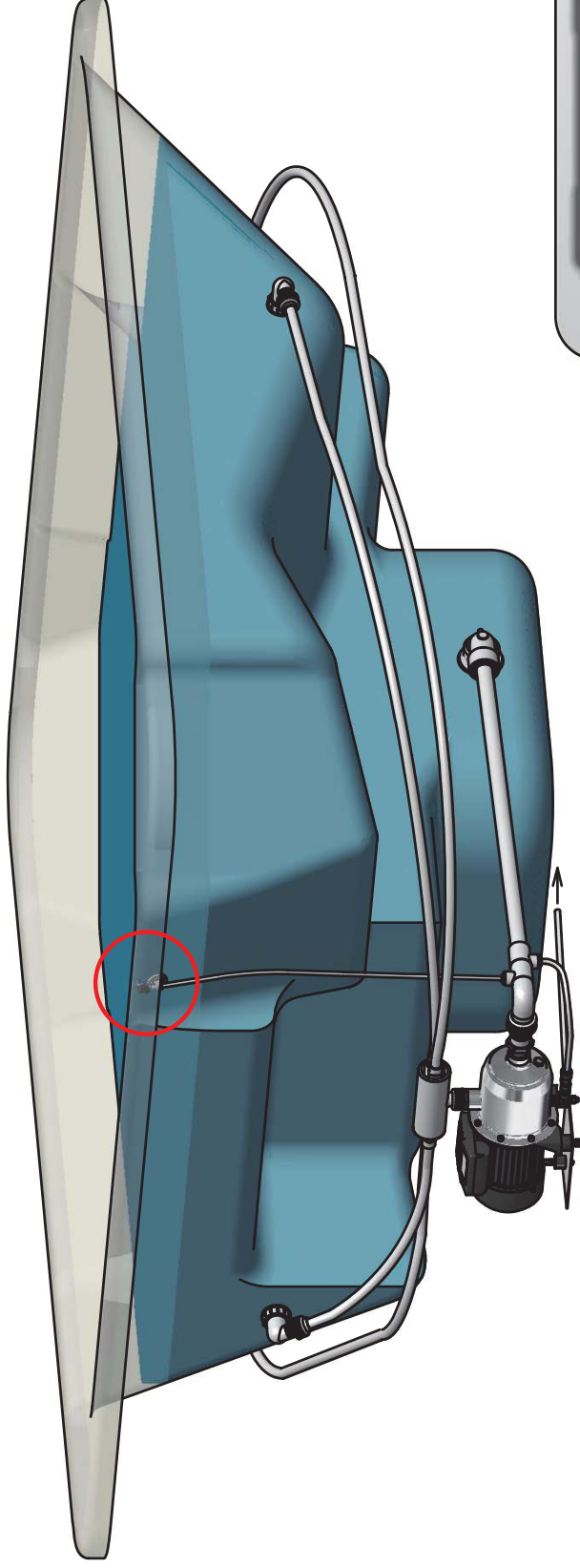

zum Absperrventil
to the shut-off valve

